

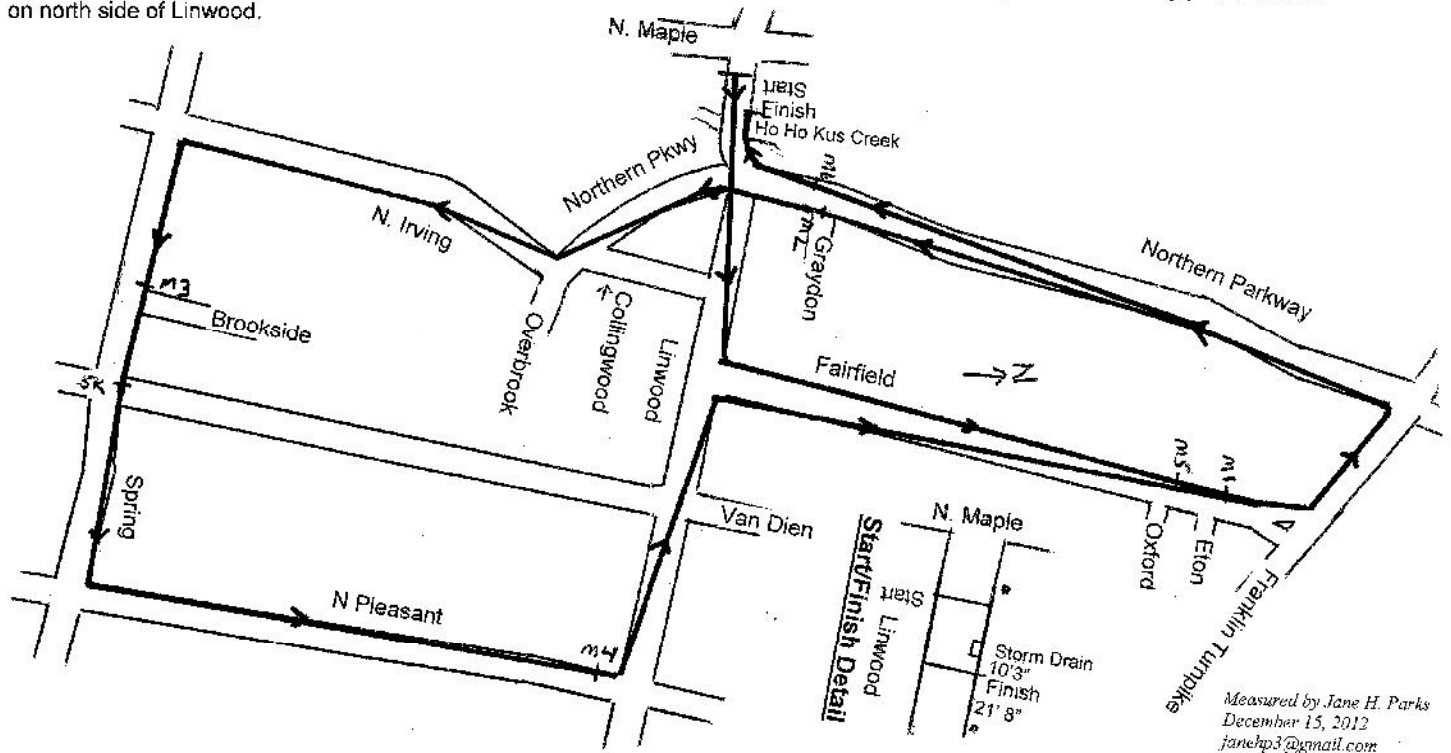

ALL DIRECTIONS ARE GIVEN RELATIVE TO THE RUNNING DIRECTION.

- Start:** On Linwood, 18 inches east of the center of utility pole 1961P on the left (north side) of road.
- Mile 1:** On Fairfield after Eton, 6 feet 8 inches before utility pole 62959 RW on the right.
- Mile 2:** On Northern Parkway, 5 feet after the manhole in middle of Northern Parkway on the south side of the intersection with Graydon.
- Mile 3:** On Spring, 18 inches after storm drain on the left just before intersection with Brookside on the left.
- 5K:** On Spring, in intersection with S. Van Dien, 9 feet 6 inches after the easternmost cross walk line on the west side of Spring.
- Mile 4:** On N. Pleasant, 4 feet 10 inches after the grey metal utility box on the right and 1 foot 9 inches before the sidewalk to #178 on the left.
- Mile 5:** On Fairfield, 16 feet before utility pole 62921RW on the right on the north east corner of Oxford and Fairfield.
- Mile 6:** On Northern Parkway before turn onto Linwood, 37.5 feet before unmarked lamp post on right which is before house # 241 on left.
- Finish:** On Linwood 10 feet 3 inches east of storm drain on north side of Linwood and 21 feet 8 inches west of utility pole 2459RW on north side of Linwood.



Ridgewood 5K 2008
Ridgewood, NJ 07450

NJ08528JHP
Expires 12/31/2018



ALL DIRECTIONS ARE GIVEN RELATIVE TO THE RUNNING DIRECTION.

Start: On Linwood 6 inches west of second post on metal rail on bridge counting from eastern side of bridge, and 9 feet west of expansion joint on left(north) side of eastern end of bridge and 26 feet west of utility pole 3882RW on left (north) side of Linwood.

Mile 1: On S. Irving, 4 feet before storm drain on left at southeastern corner of intersection with Addison Place and 12 feet before utility pole 60803RW on left.

Mile 2: On N. Pleasant after intersection with Ridgewood, 8 feet after utility pole 60566RW on right.

Mile 3: On Linwood at water cover in street on Linwood by manhole on southwest corner of intersection with Northern Parkway.

Finish: On Linwood 10 feet 3 inches east of storm drain on north side of Linwood and 21 feet 8 inches west of utility pole 2459RW on north side of Linwood

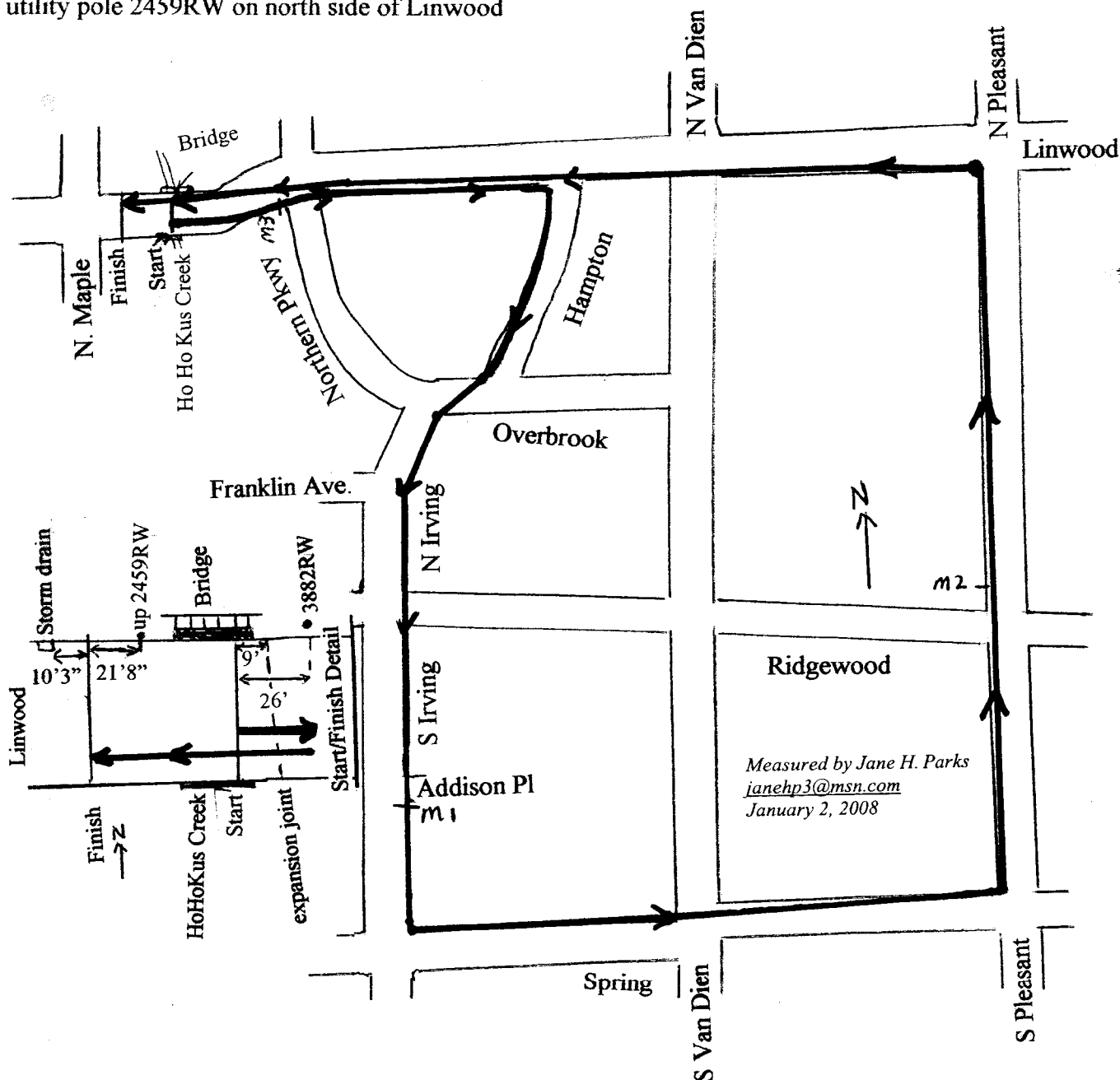

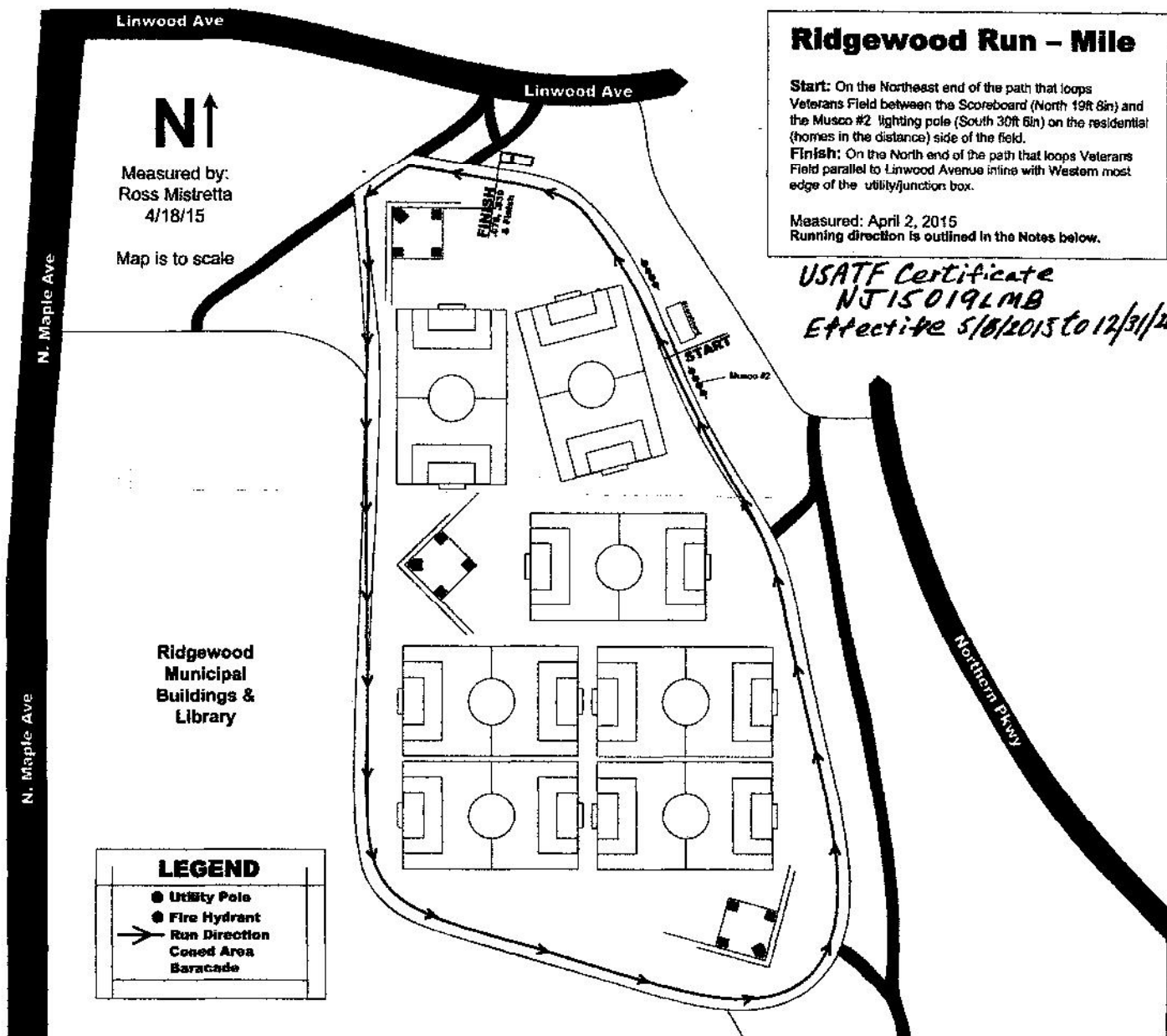

All Directions are provided relative to the running direction:

Start: On the Northeast end of the path that loops Veterans Field between the Scoreboard (North 19ft 8in) and the Musco #2 lighting pole (South 30ft 6in) on the residential (homes in the distance) side of the field.

Mile .078: On the North end of the path that loops Veterans Field parallel

Mile .539: to Linwood Avenue inline with Western most edge of the utility/junction box.

Notes:

Participants will proceed (.078 of a Mile / 411.84 ft) Northwest (counter clockwise) bleeding left with the contour of the oval pathway across the top of the Veterans Park Path past the junction/utility steel box (on right) then continuing on the closed loop counter clockwise one (1) full rotation back to the same junction/utility steel box (.461 of a Mile / 2434.08 ft) then completing a second full rotation or loop in the same counter clockwise direction (.461 of a Mile / 2434.08 ft) to the junction/utility steel box's west most end which completed (1 Mile / 5280ft and signifies the Finish.

The shortest distance through (ingress/egress) will be taken throughout the Veterans Park Loop. True tangents will be reflected through all residential sections of the course.

DETAILED START/FINISH

